

HRP Associates, Inc.

Creating the Right Solutions Together

January 13, 2010

Mr. Stephen Goldblum
Newtown Transload, LLC
30 Nutmeg Drive
Trumbull, CT 06611

**RE: MATERIAL TESTING REPORT FOLLOW UP
(HRP #NEW1800.SW-05)**

Dear Mr. Goldblum:

As you requested, this letter is a follow up to our letter-report dated December 4, 2009 regarding the testing of masonry demolition material that was stockpiled and used as fill material at the Shepaug Terminal at 30 Hawleyville Road in Newtown, CT. The materials were red brick, yellow brick, and concrete, and came from a residential housing complex formerly located in Westchester County, NY. The following describes the sampling location and methods used for the testing.

As you know, eight (8) locations were sampled and discrete samples of each material were collected at each location. The enclosed Figure 1 shows the approximate location of the eight sampling areas. Six (#1 - #6) were located in the stockpile, and two (#7 & #8) were located within the areas where the material was used as fill.

Each sampling area was approximately 10' by 10' square. The upper 2' of material was manually moved and the samples were collected from a 2' depth. Within each of the eight exposed areas several pounds of each material (i.e., red brick, yellow brick, and concrete) were randomly selected and placed in separate locking plastic bags. All bagged samples were immediately placed in coolers supplied by York Analytical Laboratory containing freezer packs, and were delivered under strict chain-of-custody to the lab on the same day. York, which holds CT Department of Public Health License PH-0723, conducted all analyses utilizing appropriate DEP, EPA, Standard Methods, and ASTM methods.

In our opinion, the sampling of the masonry material was representative and was conducted in accordance with general industry practices in the environmental field. Please contact me if you have any questions or concerns, or if you need additional information.

Sincerely,

HRP ASSOCIATES, INC.

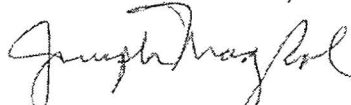

Joseph Magdol, P.E., LEP
Senior Project Manager

Enclosure – Figure 1, Material Sampling Locations

CONNECTICUT

197 Scott Swamp Road
Farmington, CT 06032
800-246-9021
860-674-9570
FAX 860-674-9624

999 Oronoque Lane
Suite 102
Stratford, CT 06614
203-380-1395
FAX 203-380-1438

FLORIDA

2435 US Highway 19
Suite 550
Holiday, FL 34691
888-477-1877
727-942-2115
FAX 727-942-2113

INDIANA

7965 East 106th Street
Suite 116
Fishers, IN 46038
800-246-9021
317-570-4851
FAX 317-570-4852

NEW YORK

1 Fairchild Square
Suite 110
Clifton Park, NY 12065
888-823-6427
518-877-7101
FAX 518-877-8561

SOUTH CAROLINA

1327 Miller Road
Suite D
Greenville, SC 29607
800-752-3922
864-289-0311
FAX 864-281-9846

www.hrpassociates.com

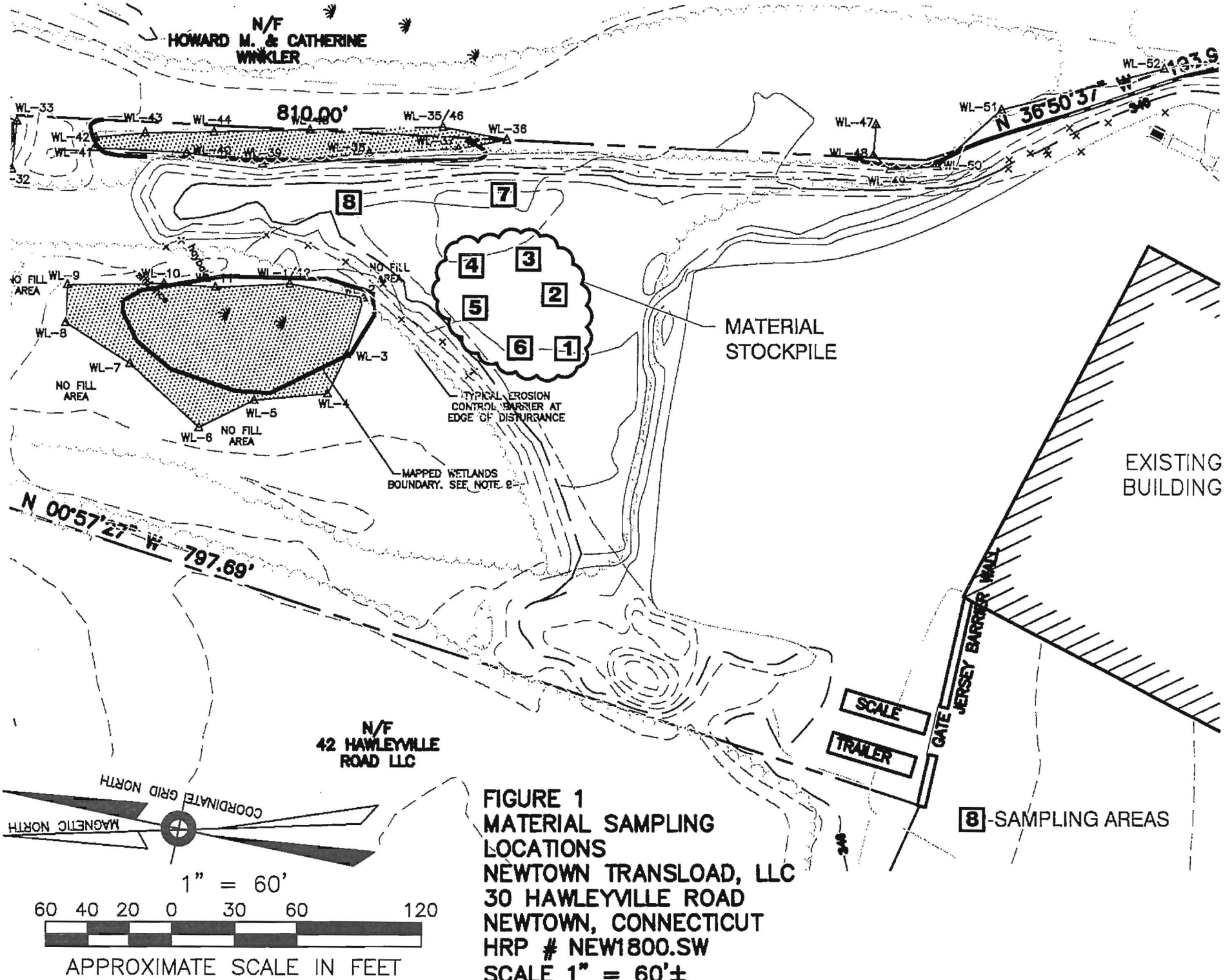

FIGURE 1
MATERIAL SAMPLING
LOCATIONS
NEWTOWN TRANSLOAD, LLC
30 HAWLEYVILLE ROAD
NEWTOWN, CONNECTICUT
HRP # NEW1800.SW
SCALE 1" = 60'±